

Model:

MY-12LS605A

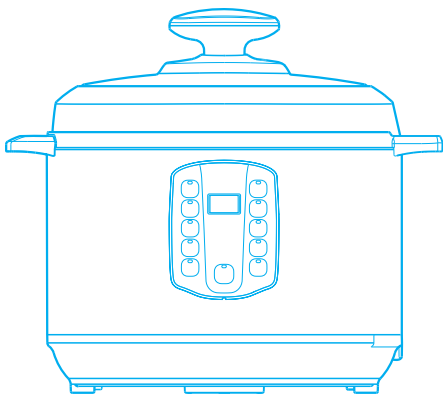

(Pictures are for reference only, actual product may differ from pictures shown.)







Table of Contents

Important Safeguards.....	01
Specifications	01
Product Diagram	02
Notice Prior to Use	03
Cooking Preparation	04
Function Selection	05
Safe Cover Opening	06
Cooking Examples	06
Timer Function	06
Keep-warm Function.....	07
Care and Maintenance	07
Safety Cautions	07
Cautions	08
Cleaning	10
Storage	10
Circuit Diagram	10
Troubleshooting	11
Warranty Card.....	12

Important safeguards

1. Before using this product, please read this User Manual carefully.
2. Do not place the unit on an unstable location. It is dangerous to use it on a newspaper, foam or other object that may easily block the vent hole at the bottom.
3. Never use it in a place which is near water or fire. Do not use it in a place exposed to direct sunshine or oil splash. Put it in a place out of the reach by children.
4. Never place the product, power cord or plug in water or other liquid.
5. If a spare part such as supply cord and plug is damaged or the product fails, stop using the product immediately and disconnect from mains power. For electrical safety any repairs to the product must be carried out by a qualified electrical person only.
6. Never make unauthorised replacement of any spare part inside the pressure cooker, as this may cause electric shock, fire or injury.
7. Before use each time, be sure to check the anti-block shield, float valve and exhaust valve for obstruction, wipe the surface of the inner pot and the heating plate to confirm they are free of any foreign object; Check the exhaust valve for sealing location.
8. When in use, never hang the power cord on a location which may easily trip over.
9. Avoid cooking food such as laver and oat meal in the pot, as they may easily clog the anti-block shield.
10. When cooking dry food, please soak for a period of time.
11. The maximum cooking amount shall not exceed the MAX level marked inside the inner pot.
12. When in operation, never move this product or open the top cover.
13. When in operation, never move your hands or face to the exhaust valve or float valve to avoid being scalded.
14. When in operation, never touch the cover with your hands to avoid being scalded.
15. After cooking, do not open the cover until you confirm that there is no pressure inside or pressure has decreased sufficiently.
16. When opening the cover after cooking, do not touch the inner pot and cover inside with your hands directly to avoid being scalded.
17. Before cleaning this product, please disconnect from mains power supply.
18. It is strictly prohibited to use this product for purposes other than those specified.
19. CAUTION: In order to avoid a hazard due to inadvertent resetting of the thermal cutout, this appliance must not be supplied through an external switching device, such as a timer, or connected to a circuit that is regularly switched on and off.
20. Keep the cooker out of reach of children. Do not allow them to use the appliance without supervision.
21. This appliance is not intended for use by persons (including children) with reduced physical, sensory or mental capabilities, or lack of experience and knowledge, unless they have been given supervision or instruction concerning use of the appliance by a person responsible for their safety.
22. This appliance is intended to be used in household and similar applications such as: -staff kitchen areas in shops, offices and other working environments; -farm houses;-by clients in hotels, motels and other residential type environments; -bed and breakfast type environments.
23. If the supply cord is damaged, it must be replaced by a qualified electrical person only or the appliance must be disposed.
24. The ducts in the pressure regulator allowing the escape of steam should be checked regularly to ensure that they are not blocked.
25. This appliance is for household use only. Do not use outdoors.

Specifications

Model	Power Supply	Power	Volume	Caliber of innerpot	Working pressure	Warm Temperature
MY-12LS605A	240V~50Hz	1000W	6L	22cm	70kPa	60°C~ 80°C
Accessories	Rice Scoop	Soup Scoop	Manual	Measuring Cup	Power Cord Components	Condensation collector
						

Product Diagram

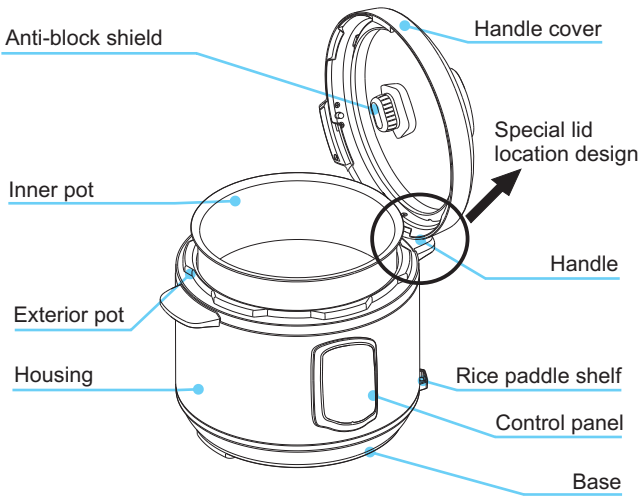
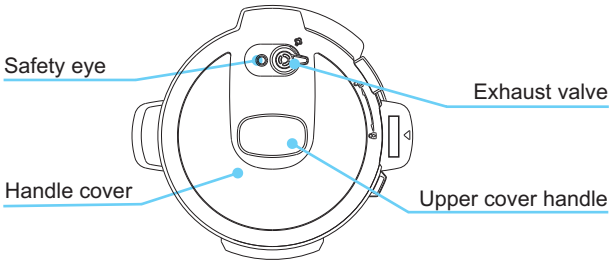

To install the condensation collector, slide it into the slot on the cooker housing. Follow the reverse order to remove it for cleaning.

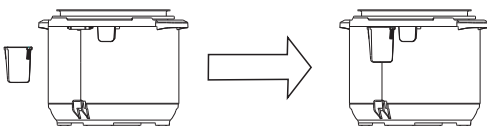

Structure diagram of float valve

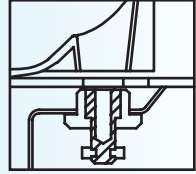

Warm tip:

1. Before use each time ,be sure to inspect the float valve anti-block shield and gasket for mounting
2. Before putting the inner pot to exterior pot, be sure to remove any debris and water attached to the outside of the exterior pot and inside of the exterior pot.
3. when moving the product , please lift with the cooker handle.
4. The housing should be free of any water, use a clean dry soft cloth to wipe the housing.

Method for using scoop holder

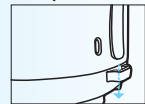

Notice Prior to Use

Before first use, please take out all accessories from the cooker body and read the User manual carefully, special care must be given to safety instructions and cautions to avoid any damage to property and/or injury.

Operation Section

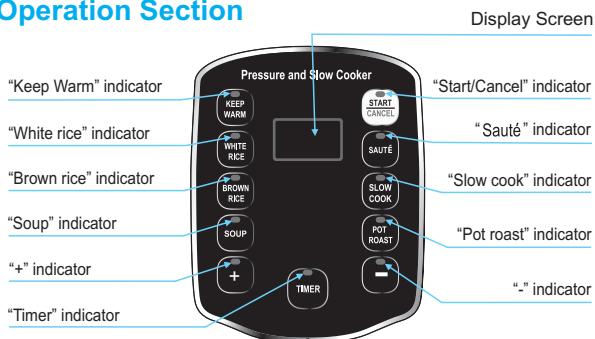

Timer function

Set the end of cooking time by pressing "+" "-" key.

Disassembly and installation of anti-block shield and gasket

Disassembly and Installation of Anti-block Shield

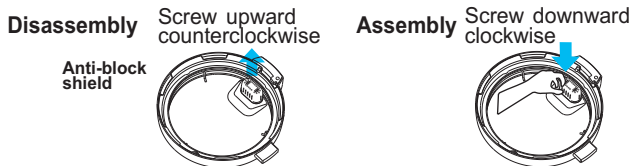

1. Prior to each use, inspect whether the gasket and anti-block shield are mounted to the upper cover.
2. After use, remove any foreign object from the gasket and anti-block shield. Keep clean to avoid odor.
3. Never pull the gasket, as pull deformation may affect sealing and pressure effect.
4. A damaged gasket should not be used, and should be replaced prior to use.

Disassembly and Installation of Gasket

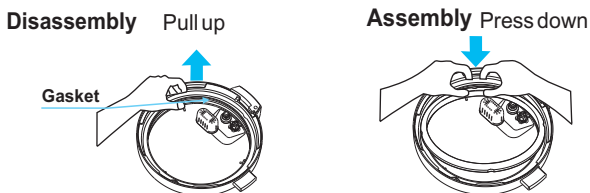

Cooking Preparation

1 Open the cover correctly

- Before first use, please take out all accessories from the cooker body and read the User Manual carefully. Special care must be given to use directions and cautions to avoid any damage to property and/or injury.
- Hold the cover handle firmly with a hand, rotate the cover to the opening position in the clockwise direction and lift the cover.

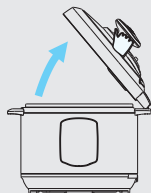

2 Check whether gasket, float valve and anti-block shield are clean. If they are stained, clean them immediately.

- Check whether the anti-block shield becomes loose. If yes, tighten it instantly.
- After inspection, mount the gasket component to the upper cover correctly.

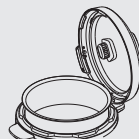

3 Take out the inner pot, and put food and water in the inner pot. Total amount of food and water shall not exceed the MAX level of inner pot height.

- When cooking, the total amount of rice and water shall not exceed the maximum level of inner pot.
- Never boil laminated food (e. g. laver, kelp, etc.) and shattered food (e. g. corn residue and oatmeal), as they may easily clog the anti-block shield.



4 Put the inner pot in the pressure cooker

- Before that, be sure to remove any foreign object and water on the outer surface of the inner pot and also on the inner surface of the cooker;
- After putting in, rotate the inner pot lightly left to right to ensure good contact between the inner pot and heating plate.

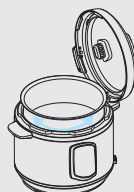

5 Close the cover completely

- After putting on the upper cover, rotate it anti-clockwise to the locking position; Make sure that it is rotated in place, otherwise, the cooker will not cook.



6 Switch on

- After switch-on, a warning tone will sound, indicating that the unit enters standby state.

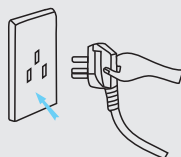

Function Selection

General Functions

1. Refer to display setting instructions on Page 4

2. Switch on

- The LED flashes and displays a red horizontal line "----", indicating that the electric pressure cooker has entered preparation state;

3. Select a required function level

- Once a function key is pressed, the indicator of a corresponding function level will illuminate (red);
- Cooking time varies with different function level. The bigger the food amount, the longer the cooking time. The cooking times listed in the table below are only for reference (e.g. food amount + water = 8 scales): Cooking time = heating time + holdup time

Functions	Default hold-up time	Temperature	Preset	Countdown	Ending state
Pot Roast	30 min	around 115°C	2~24H	30 min	OH
Soup	35 min	around 115°C	2~24H	35 min	OH
Slow cook	4 H (the whole working time)	around 95°C	N	4 H	OH
Sauté	20 min (the whole working time)	around 155°C	N	20 min	----
Brown Rice	35 min	around 120°C	2~24H	35 min	OH
White Rice	11~17 min	around 120°C	2~24H	11~17 min	OH

Note:

- To "Pot Roast, Soup, Brown Rice, White Rice", after select these functions selection, press "Start/Cancel" key, product begins to operate and the horizontal line "----" on the display screen will light. After a period, it will start to countdown the default cooking time. When the countdown time is completed it will display "OH" which means it is in keep warm mode after cooking.
- When "Slow cook, Sauté" function is selected, product begins to operate and the default cooking time will start to countdown at the same time, the time displayed is the whole working time for this selection. When the countdown time is completed on "slow cooking mode" it will display "OH" which means it is in keep warm mode after cooking. On "Saute" mode "----" on the display means the product is on standby (it does not go into keep warm function automatically on "Saute" mode).

4. Press a function key and "Start/Cancel" key, the electric pressure cooker will perform a corresponding function program selected.

- Before pressing the "Start/Cancel" key, you can re-select preset time and function level, and then press the "Start/Cancel" button to start the pressure cooker.
- The red horizontal line "----" on the display screen will light, indicating that the electric pressure cooker has entered working state.
- During operation, you can cancel current working state and return to standby state by pressing the "Start/Cancel" key.

5. After cooking, enter the warm-keeping state automatically

- After cooking, a corresponding function indicator goes out, the keep warm indicator illuminates, the display screen shows "OH", and gives out the prompt sound (10 beeps). This indicates the pressure cooker is going into keep warm state.
- In standby mode, press the "Keep warm" key, the warm indicator illuminates, and gives out the prompt sound (1 beep), indicating that the electric pressure cooker goes into keep warm state.
- Remark : Before pressing "Start/Cancel" key, please make sure the exhaust valve position is NOT at "🔒", otherwise pressure cannot build up, food cannot cook properly (Refer to Product Diagram on page 3 to identify the location of the exhaust valve).

Warm Tips:

- ★ In any mode, you can cancel current working state and return to standby state by pressing the "Start/Cancel" key.
- ★ During operation, the machine may sometimes generate the "cluck" sound, which is not malfunction.

Safe Cover Opening

Safety eye safety eye: pressure-visual valve, it can lift or drop according to the built-up pressure in the cooker. Always ensure to clean the safety eye during cleaning.

1. Disconnects the cooker from mains power.

2. Exhaust method

A. Quick opening method

- Slide the exhaust valve to the exhaust position "☞" until the safety eye falls. (for non-fluid food)
- Put a wet towel on the cover to quicken cooling until the safety eye falls. (for non-fluid food)

B. General opening method

- Have the pressure cooker to cool naturally, until the safety eye falls.

3. Open the cover

- Hold the cover handle firmly, turn the cover clockwise to the spacing edge, and pull up the cover.
- Do not open the cover until pressure inside the spot is released adequately.
- Never pull out the exhaust valve when it is exhausting.
- For fluid foods (porridge and sticky liquid), do not slide the exhaust valve for exhaust when cooking is just finished, and otherwise the food will eject from the exhaust valve core. Be sure to disconnect the power supply, have the unit cool naturally or put a wet towel around the cover to speed up cooling until the safety eye falls, and finally open the cover.
- When large quantity of food is cooked, do not exhaust immediately after cooking. It is recommended to open the cover and have the food after some time of Keep Warm.

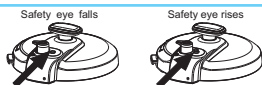

Cooking Examples

Timer Function (Content in this section can be read selectively based on actual configuration)

1. Finish cooking preparation according to Page 4

2. Select a corresponding function level

- When any function key is pressed after preparation, a corresponding function indicator illuminates; you can also change another function before "Start/Cancel" key. (To cancel the operation, press the "Start/Cancel" key)

3. Press "Timer" key to set end time of cooking

MY-12LS605A unit is equipped with 24-hour preset function (except Sauté, Slow cook), which can be operated as follows;

- Select the desired function .
- Press the "Timer", "+", and "-" button to adjust the preset cooking time.
- Timer time should not exceed 24 hours, if so, it will return to "2.0"
- When timer is set, press "Start/Cancel" key and the time displayed on the screen means working end time of pressure cooker. (to cancel the operation, press the "Start/Cancel" key again)

4. After cooking, the unit enters the warm state automatically

After preset time elapses, after cooking, the keep warm indicator illuminate and the unit will go into keep warm state, it is not recommend to keep warm for a long period of time.

Keep-warm Function

- After cooking, the electric pressure cooker goes into the warm state automatically; in the warm state, the warm indicator is bright, and "OH" is shown on the display screen;
- You can also in standby perform the warm function by pressing the "Keep Warm" key;
- The Keep Warm temperature is 60-80°C;
- Optimal Keep Warm time is less than 8 hours.



Care and Maintenance

- Regular care or maintenance is essential in ensuring that this product is safe for use.

When the following circumstances take place	Solutions
<ul style="list-style-type: none"> ● Power cord and plug suffer from expansion, deformation, discoloration, damages, etc. ● A portion of the power cord and the plug are hotter than usual. ● Electric pressure cooker heats abnormally, emitting a burnt smell. ● When power-on, there is an unusual sound or shock. 	DO NOT USE. Disconnect from mains power. Have the cooker inspected by a qualified electrician or the item must be disposed.
<ul style="list-style-type: none"> ● There is dust or dirt on the plug or socket. 	Remove dust or dirt with a dry brush.

Safety Cautions

For safety, please observe the following caution signs displayed:

- Meanings of icons displayed:

Indicates "Prohibition"	General Prohibition	Contact Forbidden	Unplug
	Disassembly Forbidden	Drenching Forbidden	
Indicates "Compulsory" Content	Wet Hand Forbidden	Must Be Carried Out	

- Ignoring these signs can/may cause injuries.

Warning | violation of warnings may cause personal death and serious injuries

Caution | violation of cautions may cause injuries to persons and properties.

Cautions

⚠ CAUTIONS

Please use a 240V-50Hz socket

- Fire or electric shock may occur if 240V AC-50Hz is not used.

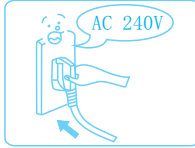

A socket shall be used independently.

- Please use an individual socket with earthed wire of more than 10A rated current;
- Joint use of the same socket with other appliance may cause unusual heat and fire.

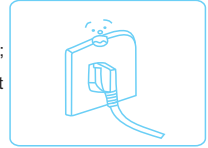

Using other cover during heating is strictly prohibited

- It is strictly prohibited to use non-brand cover during heating.
- May cause electric shock or other serious injury.

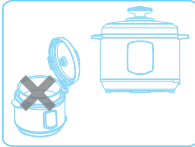

Stop the use of a damaged power cord

- The damaged power cord must be replaced with a special flexible cord or a special component bought from the manufacturer or service agency.

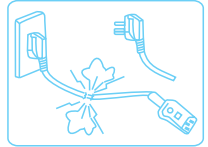

Do not insert foreign object

- Do not insert foreign objects such as metal scraps and needles into a gap.
- May cause electric shock or unusual action.

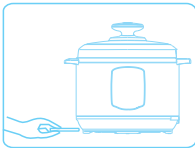

Keep away from children

- Place it away from children.
- This may cause burn or electric shock.

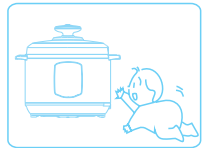

No modifications

- It is prohibited to modify or repair the unit by a non-technician.
- As this may cause fire or electric shock.
- Please send it to a designated service agency for repair or replacement of spare parts.

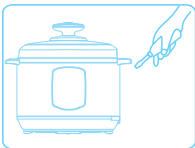

Do not wash or immerse it in water

- As this may cause electric shock and short circuit.

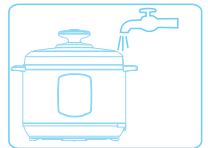

Warning on cover lifting

- When the electric pressure cooker does not work, there is no pressure inside the pot and the float valve falls down;
- When the unit works, pressure inside is on the rise, and so is the float valve. Do not open the cover forcibly until pressure is completely discharged;
- Otherwise scald or other injury may be caused.

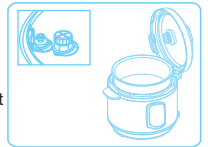

Regular inspection

- Carry out regular inspection of the exhaust valve and anti-block shield to make sure that they are unobstructed;
- Do not add any heavy object to the exhaust valve or replace it with other object.

Cautions

CAUTIONS

Do not insert and pull off the plug with wet hand

- May cause electric shock.

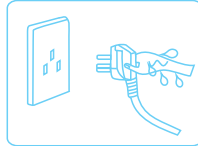

When removing the plug, be sure to pinch the plug handle

- When pulling out the plug, be sure to pinch the plug handle;
- Never pull the power cord as this may cause damage to the power cord and result in electric shock or short circuit.

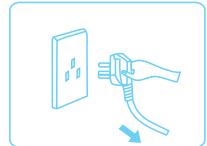

When not in use, remove plug from socket.

- May cause creepage, fire or malfunction.

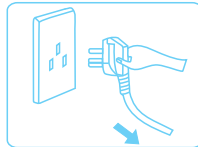

During operation, never move your hand to the exhaust valve vent

- In cooking, never move your hand or face to the exhaust valve vent to avoid scald.
- In cooking, do not cover the exhaust valve vent with a rag.



Never touch the cover during operation

- When the unit is operating, the cover has a higher temperature, so never touch it with your hand;
- This may cause scalding.

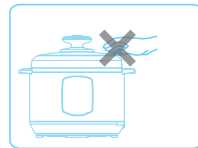

Cooking amount shall not exceed MAX level

- Food to be cooked should not exceed the MAX level, and otherwise the food may be half-cooked or failure may happen.



Use only the special inner pot

- When there is foreign object between the inner pot bottom and heating plate, first remove the foreign object before using.
- May cause overheat or abnormal operation.



Do not place the inner pot on other appliance for heating

- To avoid deformation or failure of inner pot.
- Please use the supplied special inner pot.



When moving the product, please hold the cooker handle

- To move the unit, never lift the cover handle directly to prevent the cover from falling down.

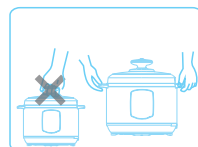

Never use the product in following places

- Unstable place;
- Places near water or fire;
- Adjacent to walls and furniture;
- Places exposed to direct sunshine or oil splash.

Cleaning

1. After each use, give timely cleaning of the product.
2. Before cleaning, unplug the unit and carry out cleaning and maintenance after the product cools down completely.
3. Take out the cover and inner pot, wash them with a detergent, rinse with fresh water and then wipe them dry with a soft cloth.
4. Using clear water, clean the cover, including the gasket, exhaust valve, anti-block shield, exhaust valve core and float valve, and wipe it clean with a rag. After cleaning install it on the cover correctly .
5. Clean the cooker body with a rag. Do not immerse the cooker in water or wash with splashing water.

Storage

1. Always unplug the removable power cord and allow the unit to cool down before storage. Place the removable power cord, measuring cups and serving spoons inside the removable cooking bowl.
2. Lock the safety locking lid to ensure that the unit cannot be dropped when moved. To prevent aromas, moulds and odours, never store your Pressure Cooker closed with safety locking lid locked in place. Store the Pressure Cooker in a convenient position on the bench top, or in the cupboard.
3. Always store the Pressure Cooker in an upright position. Do not store anything on top of the Pressure Cooker.

Circuit Diagram

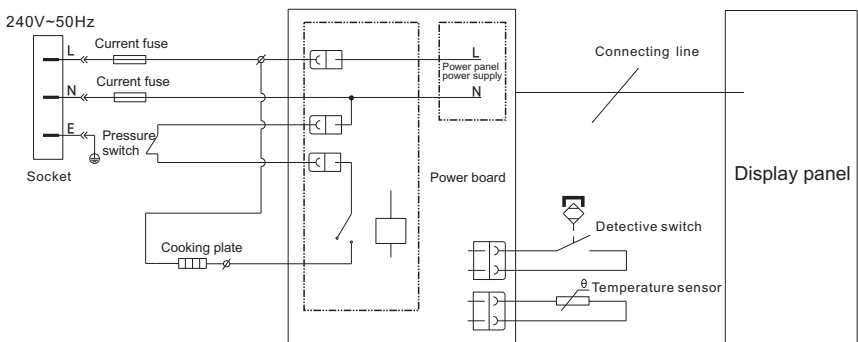

Troubleshooting

The following unusual cases are not completely caused by mechanical failures.

Please carry out a careful examination before sending the unit for repair.

S/N	Problem	Possible Reason	Solution	
1	Difficult to close the cover	Gasket not positioned well	Locate the gasket well	
		Push rod jammed by float valve	Push the push rod lightly with a hand	
2	Difficult to open the cover	Float valve fails to fall after steam release	Press the float valve lightly with chopsticks	
		Pressure exists inside the cooker	Open the cover after the pressure lowers down	
3	Leakage from cover	No gasket	Put the gasket according to the requirement	
		Food leavings attached to gasket	Clean the gasket ring	
		Gasket worn	Replace the gasket ring	
		Cover not closed firmly	Close the cover again	
4	Leakage from float valve	Food leavings attached to float valve gasket ring	Clean the float valve gasket	
		Float valve gasket ring worn	Replace the float valve gasket	
5	Float valve unable to rise	Excessively little food and water inside pot	Put food and water according to the rule	
		Little leakage from cover or exhaust valve	Send it to the service agency for inspection	
6	Exhaustion from exhaust valve does not stop	Exhaust valve not in sealing position	Slide the exhaust valve to the sealing position	
		Pressure control fails	Send it to the service agency for maintenance	
7	Lamp not bright after power on	Bad contact with socket	Please inspect the socket	
8	All lamps flash	C1 appears on nixie tube	Sensor fails	Send it to the service agency for inspection
		C2 appears on nixie tube		
		C5 appears on nixie tube	Temperature is too high because there is no water inside the inner pot	Add water as required
		C6 appears on nixie tube	Temperature is too high because inner pot is not placed	Put the inner pot properly
9	Rice half cooked/too hard	Too little water added	Add more water	
		Cover closed prematurely	After the time is up, release steam and open the cover in 5 minutes	
10	Rice too soft	Too much water added	Reduce water level	

Warranty Card

12 Month Warranty

Thank you for your purchase from Kmart.

Kmart Australia Ltd warrants your new product to be free from defects in materials and workmanship for the period stated above, from the date of purchase, provided that the product is used in accordance with accompanying recommendations or instructions where provided. This warranty is in addition to your rights under the Australian Consumer Law.

Kmart will provide you with your choice of a refund, repair or exchange (where possible) for this product if it becomes defective within the warranty period. Kmart will bear the reasonable expense of claiming the warranty. This warranty will no longer apply where the defect is a result of alteration, accident, misuse, abuse or neglect.

Please retain your receipt as proof of purchase and contact our Customer Service Centre on 1800 124 125 (Australia) or 0800 945 995 (New Zealand) or alternatively, via email at customer.satisfaction@kmart.com.au for any difficulties with your product. Warranty claims and claims for expense incurred in returning this product can be addressed to our Customer Service Centre at 690 Springvale Rd, Mulgrave Vic 3170.

Our goods come with guarantees that cannot be excluded under the Australian Consumer Law. You are entitled to a replacement or refund for a major failure and compensation for any other reasonably foreseeable loss or damage. You are also entitled to have the goods repaired or replaced if the goods fail to be of acceptable quality and the failure does not amount to a major failure.

For New Zealand customers, this warranty is in addition to statutory rights observed under New Zealand legislation.

Special Declaration

Addition: Any technical improvements shall be placed in the revised manual without notice; for any changes in appearance and color, those of the actual product shall prevail.